

OL 700-10

Programmable Precision Power Supply for LEDs



The OL 700-10 Programmable Precision Power Supply offers a lower cost solution to accurately controlling the drive currents of LEDs and small incandescent sources. It is completely controlled by a remote computer via a USB interface.

The OL 700-10 can be configured to run in current or voltage regulated modes with programmable over current and voltage limits.

The control program gives full remote access to the current source setting. Active X™ is also provided for custom programming.

Control of the OL 700-10 is integrated into the application software of the OL 770-LED spectroradiometer to provide a total measurement package, incorporating remote switching and time setting. The OL 700-10 is also available as a stand-alone power supply and comes complete with all necessary software controls for USB interface.

Specifications

Current Source/ Measure Range	
OL 700-10-2000.....	± 2000 mA
OL 700-10-200.....	± 200 mA
OL 700-10-50.....	± 50 mA
Current Source/ Measure Resolution	
OL 700-10-2000.....	0.1 mA
OL 700-10-200.....	0.01 mA
OL 700-10-50.....	0.0025 mA
Current Source/ Measure Accuracy	0.02% of Full Scale
Voltage Source/ Measure Range	± 6.0 Volts
Voltage Source/ Measure Resolution	0.3 mV
Voltage Source/ Measure Accuracy	0.02% of Full Scale
Size	10 in. (25.4 cm) x 6.5 in. (16.5 cm) x 3.8 in. (9.65 cm)
Weight	5 lbs (2.2 kg)
Operating Temperature	0° – 40°C (32° - 100°F)
Operating Humidity	0 - 90% non-condensing
User Interface	Virtual interface via PC, USB Connection

OL 700-10 Front Panel

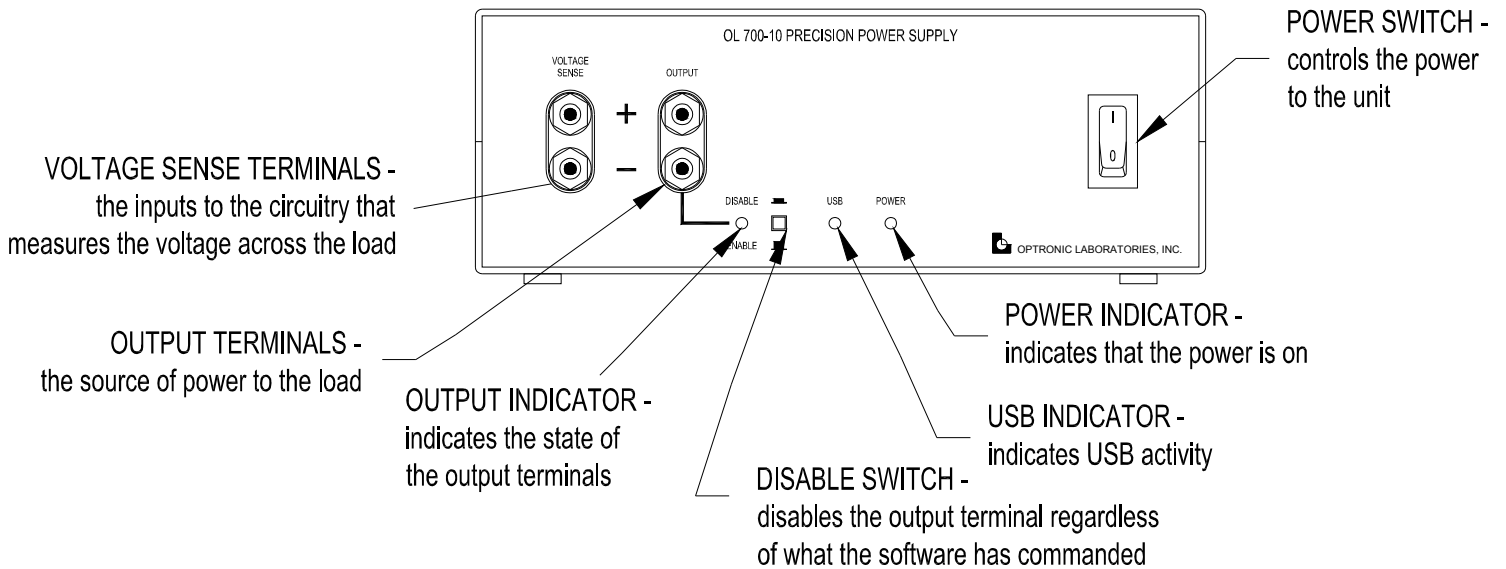

P001462E

OL 700-10 Rear Panel

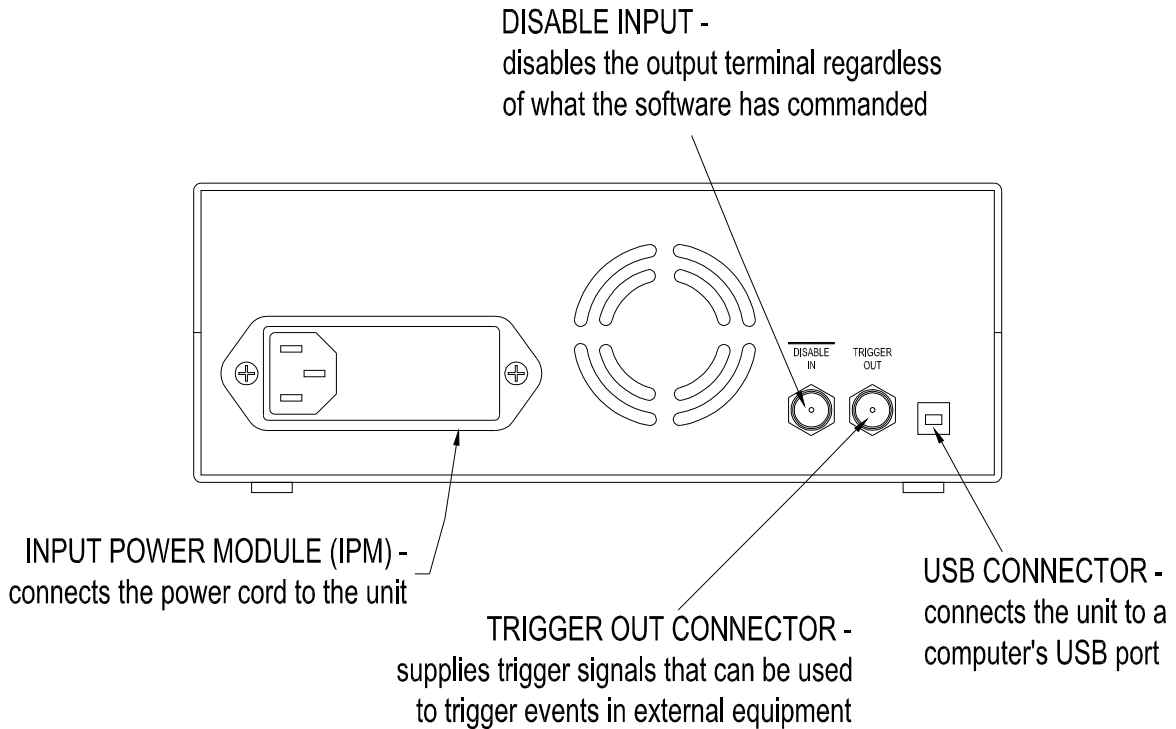

P001463A